



N3B-Los Alamos
 1200 Trinity Drive, Suite 150
 Los Alamos, New Mexico 87544
 (505) 257-7690



Environmental Management
 Los Alamos Field Office
 1200 Trinity Drive, Suite 400
 Los Alamos, New Mexico 87544
 (240) 562-1122

Date: December 7, 2021
Refer To: N3B-2021-0391

Carol Johnson
 Enforcement and Compliance Assurance Division
 U.S. Environmental Protection Agency, Region 6
 1201 Elm Street, Suite 500 (6 ECD-WR)
 Dallas, Texas 75270-2102

Subject: NPDES Permit No. NM0030759 – Certification of Installation of Enhanced Control Measures at A-SMA-1.1 and A-SMA-3

Dear Ms. Johnson:

This letter and enclosures are being submitted in accordance with the requirements of the U.S. Environmental Protection Agency (EPA) National Pollutant Discharge Elimination System (NPDES) Permit No. NM0030759, for discharges of storm water at Los Alamos National Laboratory. The permit was issued to Los Alamos National Security, LLC (LANS) and the U.S. Department of Energy, effective November 1, 2010, and on April 30, 2018, responsibilities, coverage, and liability transferred from LANS to Newport News Nuclear BWXT-Los Alamos, LLC (N3B). As specified in Part I, Section E.1(c), "Permittees shall certify completion of installation of control measures under this subsection to EPA within 30 days of completion of all such measures at the Site."

Accordingly, the documents for certification of enhanced control measures completed at Site Monitoring Areas (SMAs) A-SMA-1.1 and A-SMA-3 within the last 30 days are included as Enclosure 1 and Enclosure 2, respectively. Table 1 identifies the permitted features, SMAs, and Sites applicable to the certification. The certification was signed in accordance with 40 Code of Federal Regulations 122.22(b) and will be posted to the Individual Permit public website (<https://ext.em-la.doe.gov/ips>).

Table 1
SMA's Included in This Submittal
of Certification of Installation of Enhanced Control Measures

Permitted Feature	SMA	Site
A001	A-SMA-1.1	39-004(a) 39-004(d)
A006	A-SMA-3	39-002(b) 39-004(c)

If you have any questions, please contact Emily Day at (505) 695-4243 (emily.day@em-la.doe.gov) or M. Lee Bishop at (702) 218-4460 (lee.bishop@em.doe.gov).

Sincerely,



Troy Thomson
Program Manager
Environmental Remediation
N3B-Los Alamos

Sincerely,



Digitally signed by BRIAN HARCEK
Date: 2021.12.07 08:18:19 -07'00'

For

M. Lee Bishop, Director
Office of Quality and Regulatory Compliance
U.S. Department of Energy
Environmental Management
Los Alamos Field Office

Enclosure(s):

1. Certification of Installation of Enhanced Control Measures at A-SMA-1.1 (EM2021-0740)
2. Certification of Installation of Enhanced Control Measures at A-SMA-3 (EM2021-0741)

cc (letter with hard-copy enclosure[s]):
Susan Lucas-Kamat, NMED-SWQB

cc (letter and enclosure[s] emailed):
Esteban Herrera, EPA Region 6, Dallas, TX
Curry Jones, EPA Region 6, Dallas, TX
Laurie King, EPA Region 6, Dallas, TX
Brent Larsen, EPA Region 6, Dallas, TX
Chris Catechis, NMED-DOE-OB/-RPD
Steve Yanicak, NMED-DOE-OB
Stephen Hoffman, NA-LA
Peter Maggione, NA-LA
M. Lee Bishop, EM-LA
Arturo Duran, EM-LA
John Evans, EM-LA

7021 0950 0000 4460 6419

U.S. Postal Service™ CERTIFIED MAIL® RECEIPT Domestic Mail Only	
For delivery information, visit our website at www.usps.com ®.	
Dallas, TX 75270	
OFFICIAL USE	
Certified Mail Fee	\$3.75
Extra Services & Fees (check box, add fee as appropriate)	\$3.05
<input type="checkbox"/> Return Receipt (hardcopy)	\$0.00
<input type="checkbox"/> Return Receipt (electronic)	\$0.00
<input type="checkbox"/> Certified Mail Restricted Delivery	\$0.00
<input type="checkbox"/> Adult Signature Required	\$0.00
<input type="checkbox"/> Adult Signature Restricted Delivery	\$0.00
Postage	\$1.56
Total Postage and Fees	\$8.36
Postmark Here LOS ALAMOS NM 87544 12/07/2021	
Sent To Carol Johnson EPA Region 6 ECAD Street and Apt. No., or PO Box No. 1201 Elm St Suite 500 (6 ECD-WR) City, State, ZIP+4® Dallas TX 75270-2102	
PS Form 3800, April 2015 PSN 7530-02-000-9047 See Reverse for Instructions	

Michael Mikolanis, EM-LA
David Nickless, EM-LA
Cheryl Rodriguez, EM-LA
Jennifer Payne, LANL
William Alexander, N3B
Sharon Brady, N3B
Don Carlson, N3B
Emily Day, N3B
Thomas Harrison, N3B
Debby Holgerson, N3B
Jeff Holland, N3B
Audrey Krehlik, N3B
Kim Lebak, N3B
Joseph Legare, N3B
Dana Lindsay, N3B
Pamela Maestas, N3B
Jason Moore, N3B
Joseph Murdock, N3B
Joseph Noll, N3B
Gerald O’Leary III, N3B
Tashia Owen, N3B
Karly Rodriguez, N3B
Troy Thomson, N3B
Joseph Sena, N3B
Steve Veenis, N3B
Amanda White, N3B
emla.docs@em.doe.gov
n3brecords@em-la.doe.gov
Public Reading Room (EPRR)
PRS website

**Certification of Installation of Enhanced Control
Measures at A-SMA-1.1**

December 7, 2021

NPDES PERMIT NO. NM0030759

EM2021-0740

**NEWPORT NEWS NUCLEAR BWXT-LOS ALAMOS, LLC
CERTIFICATION OF ENHANCED CONTROL MEASURES****PF: A001****A-SMA-1.1****Sites: 39-004(a)
39-004(d)**

The following certification was performed in accordance with the National Pollutant Discharge Elimination System (NPDES) Permit No. NM0030759, Part I.E.1(c), which requires the Permittees (U.S. Department of Energy and Newport News Nuclear BWXT-Los Alamos, LLC) to certify the completion of the installation of control measures within 30 days of completion of the installation of all such measures at the Site.

CERTIFICATION STATEMENT OF AUTHORIZATION

"I certify under penalty of law that this document and all attachments were prepared under my direction or supervision in accordance with a system designed to assure that qualified personnel properly gather and evaluate the information submitted. Based on my inquiry of the person or persons who manage the system, or those persons directly responsible for gathering the information, the information submitted is, to the best of my knowledge and belief, true, accurate and complete. I am aware there are significant penalties for submitting false information including the possibility of fine and imprisonment for knowing violations."



Steve Veenis, Water Program Director
Environmental Remediation
Newport News Nuclear BWXT-Los Alamos, LLC

11/19/21

Date

Digitally signed by
BRIAN HARCEK
Date: 2021.12.07
08:18:36 -07'00'

For

M. Lee Bishop, Director
Office of Quality and Regulatory Compliance
U.S. Department of Energy
Environmental Management
Los Alamos Field Office

Date

**NEWPORT NEWS NUCLEAR BWXT-LOS ALAMOS, LLC
CERTIFICATION OF ENHANCED CONTROL MEASURES****PF: A001****A-SMA-1.1****Sites: 39-004(a)
39-004(d)**

In September 2018, analytical results received from extended baseline monitoring at Site Monitoring Area (SMA) A-SMA-1.1 yielded target action level (TAL) exceedances for aluminum, gross alpha, mercury, and selenium, prompting the initiation of corrective action.

In accordance with NPDES Permit No. NM0030759 (the Permit) Part I.E.1(c), the design, installation, and documentation of enhanced control measures reasonably expected to achieve compliance with TALs identified in the Permit for all Sites within the identified SMA drainage area have been completed. Included in this document are photos (listed in Table 1 and shown on pages 2 through 5) and a map (Figure 1) of the enhanced control measures to be certified.

Table 1
Enhanced Control Measure Descriptions

Photo ID	Control Measure ID	Type of Control Measure	Control Measure
1. JPG	A00106010007	Check Dam	Rock Check Dam
2. JPG	A00106010008	Check Dam	Rock Check Dam
3. JPG	A00106010009	Check Dam	Rock Check Dam
4. JPG	A00104060010	Channel/Swale	Rip Rap

**NEWPORT NEWS NUCLEAR BWXT-LOS ALAMOS, LLC
CERTIFICATION OF ENHANCED CONTROL MEASURES****PF: A001****A-SMA-1.1****Sites: 39-004(a)
39-004(d)****Photos:**

Photo ID	Control Measure ID	Type of Control Measure	Control Measure	Photo Angle
1. JPG	A00106010007	Check Dam	Rock Check Dam	Looking north

**NEWPORT NEWS NUCLEAR BWXT-LOS ALAMOS, LLC
CERTIFICATION OF ENHANCED CONTROL MEASURES**

PF: A001

A-SMA-1.1

Sites: 39-004(a)
39-004(d)



Photo ID	Control Measure ID	Type of Control Measure	Control Measure	Photo Angle
2. JPG	A00106010008	Check Dam	Rock Check Dam	Looking north

**NEWPORT NEWS NUCLEAR BWXT-LOS ALAMOS, LLC
CERTIFICATION OF ENHANCED CONTROL MEASURES**

PF: A001

A-SMA-1.1

Sites: 39-004(a)
39-004(d)

Photo ID	Control Measure ID	Type of Control Measure	Control Measure	Photo Angle
3. JPG	A00106010009	Check Dam	Rock Check Dam	Looking north

**NEWPORT NEWS NUCLEAR BWXT-LOS ALAMOS, LLC
CERTIFICATION OF ENHANCED CONTROL MEASURES**

PF: A001

A-SMA-1.1

Sites: 39-004(a)
39-004(d)

Photo ID	Control Measure ID	Type of Control Measure	Control Measure	Photo Angle
4. JPG	A00104060010	Channel/Swale	Rip Rap	Looking northeast

**NEWPORT NEWS NUCLEAR BWXT-LOS ALAMOS, LLC
CERTIFICATION OF COMPLETION OF CORRECTIVE ACTION**

PF: A001

A-SMA-1.1

Sites: 39-004(a)
39-004(d)

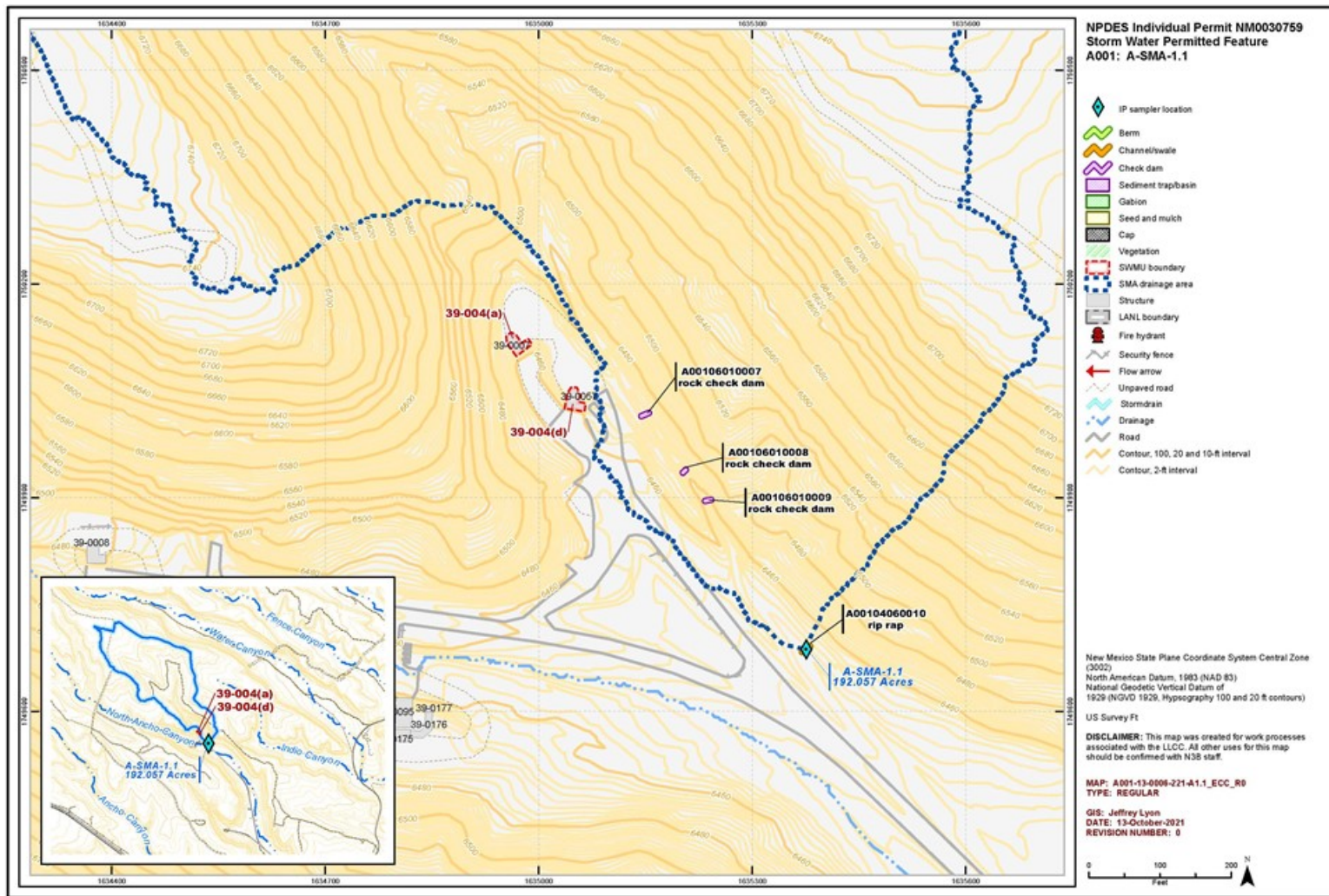

Figure 1 A-SMA-1.1 enhanced control measures

**Certification of Installation of Enhanced Control
Measures at A-SMA-3**

December 7, 2021

NPDES PERMIT NO. NM0030759

EM2021-0741

**NEWPORT NEWS NUCLEAR BWXT-LOS ALAMOS, LLC
CERTIFICATION OF ENHANCED CONTROL MEASURES****PF: A006****A-SMA-3****Sites: 39-002(b)
39-004(c)**

The following certification was performed in accordance with the National Pollutant Discharge Elimination System (NPDES) Permit No. NM0030759, Part I.E.1(c), which requires the Permittees (U.S. Department of Energy and Newport News Nuclear BWXT-Los Alamos, LLC) to certify the completion of the installation of control measures within 30 days of completion of the installation of all such measures at the Site.

CERTIFICATION STATEMENT OF AUTHORIZATION

"I certify under penalty of law that this document and all attachments were prepared under my direction or supervision in accordance with a system designed to assure that qualified personnel properly gather and evaluate the information submitted. Based on my inquiry of the person or persons who manage the system, or those persons directly responsible for gathering the information, the information submitted is, to the best of my knowledge and belief, true, accurate and complete. I am aware there are significant penalties for submitting false information including the possibility of fine and imprisonment for knowing violations."



Steve Veenis, Water Program Director
Environmental Remediation
Newport News Nuclear BWXT-Los Alamos, LLC

11/19/21

Date

Digitally signed by
BRIAN HARCEK
Date: 2021.12.07
08:18:59 -07'00'

For

M. Lee Bishop, Director
Office of Quality and Regulatory Compliance
U.S. Department of Energy
Environmental Management
Los Alamos Field Office

Date

**NEWPORT NEWS NUCLEAR BWXT-LOS ALAMOS, LLC
CERTIFICATION OF ENHANCED CONTROL MEASURES****PF: A006****A-SMA-3****Sites: 39-002(b)
39-004(c)**

In October 2018, analytical results received from corrective action monitoring at Site Monitoring Area (SMA) A-SMA-3 yielded target action level (TAL) exceedances for copper, gross alpha, and total polychlorinated biphenyls, prompting the initiation of a second round of corrective action.

In accordance with NPDES Permit No. NM0030759 (the Permit) Part I.E.1(c), the design, installation, and documentation of enhanced control measures reasonably expected to achieve compliance with TALs identified in the Permit for all Sites within the identified SMA drainage area have been completed. Included in this document are a photo (listed in Table 1 and shown on page 2) and a map (Figure 1) of the enhanced control measure to be certified.

Table 1
Enhanced Control Measure Descriptions

Photo ID	Control Measure ID	Type of Control Measure	Control Measure
1. JPG	A00606010038	Check Dam	Rock Check Dam

**NEWPORT NEWS NUCLEAR BWXT-LOS ALAMOS, LLC
CERTIFICATION OF ENHANCED CONTROL MEASURES****PF: A006****A-SMA-3****Sites: 39-002(b)
39-004(c)****Photo:**

Photo ID	Control Measure ID	Type of Control Measure	Control Measure	Photo Angle
1. JPG	A00606010038	Check Dam	Rock Check Dam	Looking west

NEWPORT NEWS NUCLEAR BWXT-LOS ALAMOS, LLC CERTIFICATION OF ENHANCED CONTROL MEASURES

PF: A006

A-SMA-3

Sites: 39-002(b)
39-004(c)

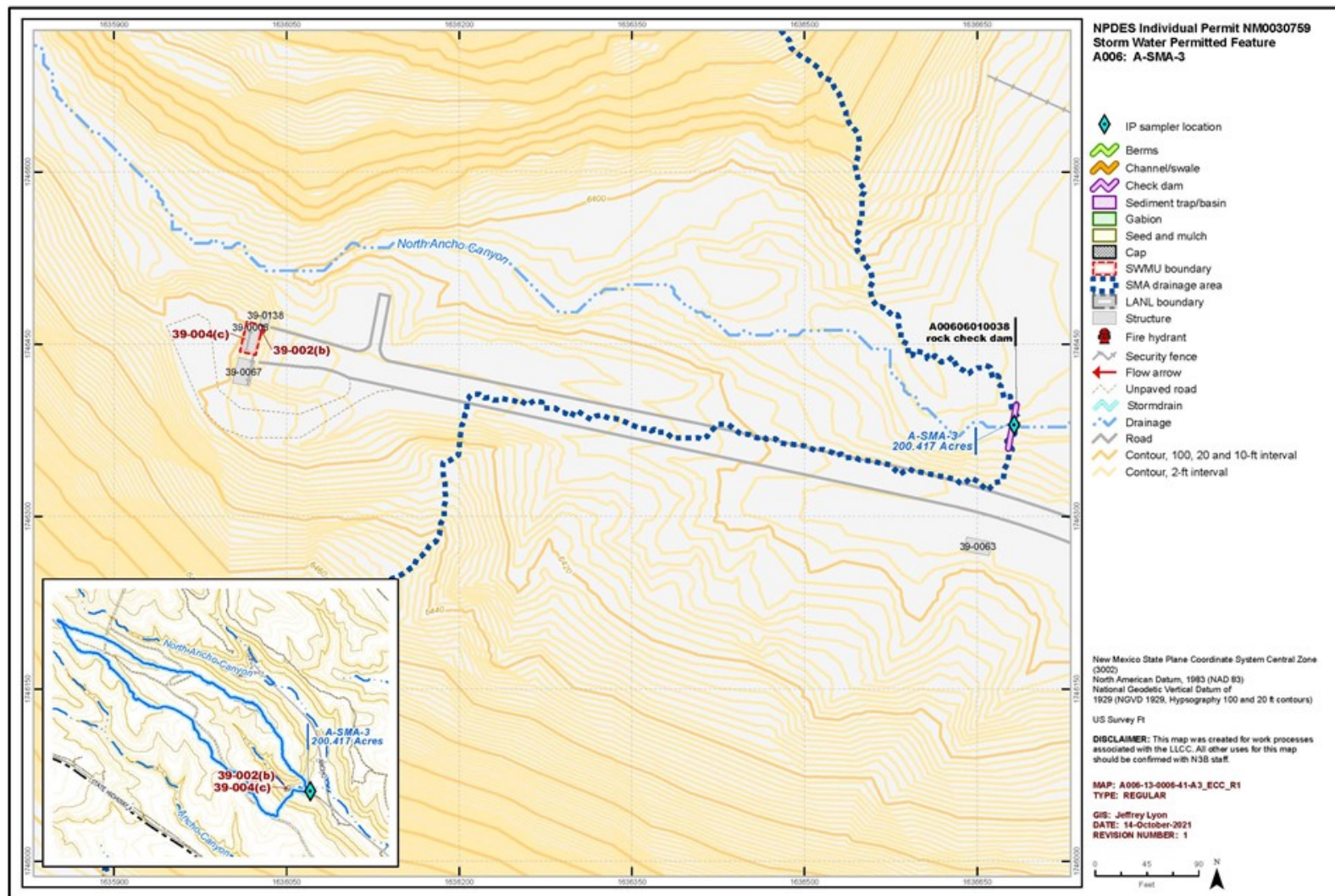

Figure 1 A-SMA-3 enhanced control measures